

## WATERPROOFING – LIQUIDS

### Liquid Asphaltic Compound

Liquid Asphaltic Compound is a damp-proof solution, used in two coats to provide a damp-proof membrane on solid floors or for protecting foundations, retaining walls, abutments, beams, lintels and similar structures against moisture and attack from sulphates contained within the soil.

#### Benefits

- Barrier to water and water vapour
- Forms a highly flexible membrane
- Easy to apply
- Application accommodates awkward details
- Once dry – resistant to frost
- Resistant to sulphates



Code	Drum Litres
LAC	25

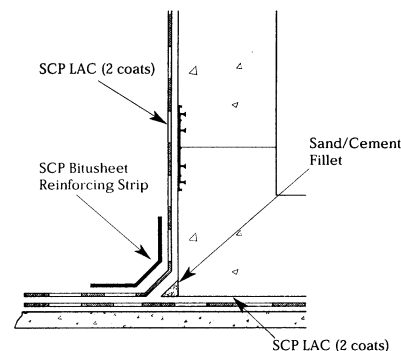

### Water Plug

Single component, rapid setting, polymer modified mortar for arresting severe water infiltration under pressure through cracks and joints in concrete and masonry in basements, underground tanks and below surface structures. It is ideally suited for sealing around pipework and forming fillets in tanking situations.



Code	Size, Kg	Yield, Litres
WAP8	8.0	4.25
WAP25	25.0	13.25

#### Advantage

- Material only requires mixing with water to give a mortar which sets in 2 minutes to arrest infiltration.
- Portland cement based mortar free from chlorides.
- Polymer modified to enhance bond and prevent washout.
- Non-shrink properties ensure a water tight seal.
- Cement base is less hazardous than traditional caustic additives.

### Bitumen Emulsion

A special blend of rubber latex and bitumen emulsion suitable for use as a waterproofer, multi-purpose adhesive and crack sealer. Brush applied.



Code	Size
BE25	25 Litres
BE200	200 Litres

Coverage approximately 0.6-0.9 sq. metres per litre.

## CONSTRUCTION CHEMICALS AND COMPOUNDS

### Release Agents

A universally accepted release agent of high specification, giving excellent release characteristics and substantial reductions of blowholes and surface blemishes. Resistant to weathering. Various grades are available depending on application.



Code	Drum litres
EX210XS	205
EX25XS	25
EX25GRP	25

Coverage approx. 25–60 sq. metres per litre.

## Mould Oil

A versatile, high quality neat oil with surfactant which is ideal for use on metal, timber, other formwork materials and coatings. Formulated to give optimum release and quality of finish to concrete over a wide range of mix designs. Spray applied.



Code	Drum litres
INFO205	205
INFO25	25

Coverage approx. 13–30 sq. metres per litre.

## Curing Agents

A large range of highly specified curing membranes to suit every situation. Resin based giving 75% or 90% water retention while concrete cures. Available with aluminium flake for reflection of light and fugitive dye for visible application. A silicate based membrane is available for use when a further surface treatment is required. Spray applied.



Code	Item	Drum litres
R75210	Resin 75%	210
R7525	Resin 75%	25
R90210	Resin 90%	210
R9025	Resin 90%	25
R90210A	Resin 90%	210
R9025A	Aluminised	25
CA205	Silicate	250
INFC205	Silicate	25
RCF25	Resin Cleaning Fluid	25

Coverage approximately 5 sq. metres per litre.

## Surface Retarders

Used for exposed aggregate finishes, and surface keying of construction joints. Mould face gel applied to shuttering with brush. Top face applied to fresh concrete with spray.



Code	Size
EXP25	25 Litre
ATFS25	25 Litre
ATFS210	210 Litre

Coverage 12–15 m<sup>2</sup> per litre (gel type)  
5 m<sup>2</sup> per litre (spray type)

## Dustproof and Hardener

A concentrated silicate solution for treatment of new or old concrete giving a superior surface resistance to abrasion and chemical attack with the added bonus of dust reduction. Applied in 2-3 coats depending on the type of concrete. Spray applied.



Code	Drum litres
EH25	25

Coverage approximately 5–20 sq. metres per litre.

## Matchpatch

A specialised 'structural' grade cementitious repair cement, ideal for the repair of *in-situ* or precast concrete, masonry, screeds, renders, brickwork and blockwork. It can be used horizontally, vertically or overhead without any need for primers or support. Trowel applied. 1kg yields 500cm.



Code	Keg Kg
FPW 25	25.0 (White)
FPG 25	25.0 (Grey)