

# K-FORM PVC SCREED RAIL



## DESCRIPTION

K-FORM UPVC Screed Railing provides the construction industry with an economical, efficient and environmentally friendly alternative to steel shuttering.

Made from recycled materials, K-FORM is lightweight, durable and does not require removal after concrete pouring. It is easily cut to length on site and has pre-drilled holes in the vertical face for locating steel dowels bars and in the base for mortar anchoring. Furthermore, K-FORM's patented design features a built in expansion joint, end clips for joining and a removable top strip for joint sealing.

Designed to be used with twin beams, bunyan rollers or vibro strikes, K-FORM's K135 disposable railing replaces steel forms where joints are needed.

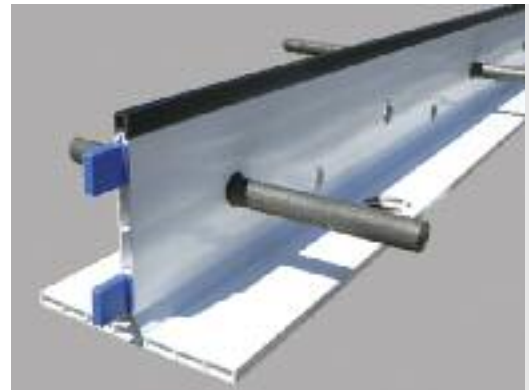

## FEATURES & SPECIFICATIONS

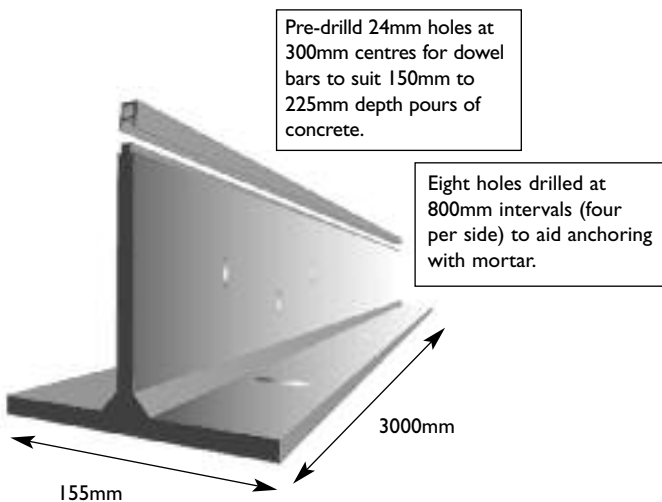

- Designed for a pour of 150mm to 225mm thick concrete
- Enables adjoining bays to be poured consecutively
- Pre-drilled holes in base for anchoring with mortar
- Pre-drilled holes in vertical face for locating dowel bars
- The profile is made from UPVC and has a built in expansion joint
- Once concrete is poured, K-FORM is left in place; there is no need to remove and clean
- Separate wear strip can be removed once concrete is set to allow joint sealing

## ADVANTAGES

- Saves time and money
- Simple to use; the "click together" assembly means no specialist tools are required
- Lightweight; one person can install therefore reducing labour costs
- No removal or cleaning is required after use
- Increased pouring time means projects can be completed quicker
- Made from recycled materials
- Fuel and oil resistant
- Will not rot or rust
- Pre-drilled holes for dowel bars
- Manufactured from durable UPVC - non-metallic and non-conductive
- Integral expansion joint
- No anchoring with metal stakes
- Removable top strip
- Easy to seal concrete sections
- No diamond cutting
- No puncturing of DPM
- Available in 3 metre rails

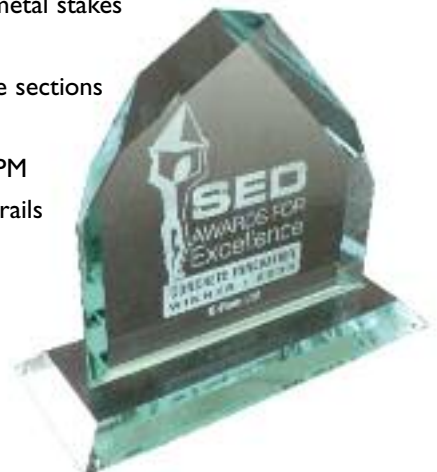

SED Award for Excellence in Concrete Innovation

## METHOD OF APPLICATION

K-FORM is ideal for concrete slabs of 150mm to 225mm. The 135mm section is simply laid down on a mortar bed or a lean mix to the required finished height.

1. Set up your string line
2. Cut the first top strip in half, attach to first rail and fit joint clip
3. Place spots of bedding mortar on sub base at intervals of 800mm to correspond with holes in the base
4. Place the rail on the bed and gently tap down with a rubber mallet until the top of the wear strip is at the desired level
5. Place more bedding for the next rail, as in step 3
6. Join the second rail to the first with the joint clip
7. Fit full length of top strip across the rails
8. Tap down the rail, as in step 4
9. Each 3m K-FORM rail has pre-drilled 24mm holes for dowel bars
10. Once the bedding mortar has cured, you can start pouring concrete
11. K-FORM rails stay in place, therefore adjoining bays can be poured one after the other
12. Once the concrete has cured, the top strip can either be left in place or removed. The gap can subsequently be filled with a joint sealant



**K-FORM**  
Concrete shuttering made easy.



**inform**

Official distributors for K-FORM

INFORM (UK) Ltd  
Industrial Park  
Ely Road, Waterbeach  
Cambridge CB25 9PG  
Tel: 01223 862230  
Fax: 01223 440246

Web: [www.informuk.co.uk](http://www.informuk.co.uk)  
Email: [general@informuk.co.uk](mailto:general@informuk.co.uk)